



INS LifeGuard

## LifeGuard VR Call Point

With Voice Recognition – simply speak or press the button to activate an alarm. The VR Call Point is compatible with the SmartHome IPD, SmartHome LGX, and L-Series Diallers.



Our new **LifeGuard VR Call Point** uses advanced speech recognition technology to recognise pre-set vocal commands or keywords to trigger specified actions, such as calling for help. It also features a large help button that can be pressed to trigger an alarm.

In critical situations, such as falls, medical problems or emergencies, users may not be able to reach the call point. With the VR Call Point they have two ways to summon assistance.

Whichever way it's triggered, the VR Call Point raises an alarm in INS LifeGuard's Emergency Response Centre, which is staffed by qualified nurses and other healthcare professionals 24/7.

Our Call Centre is staffed by highly qualified and experienced nurses whose qualifications and clinical knowledge are far greater than the 'first aid attendants' commonly used in the industry.

The fact that all alarms are handled by qualified nurses is unique to INS LifeGuard and we feel it's an important distinction. It means emergency personnel can be engaged quickly if required, and our nurses can not only share personal details, but also medical information that could save a life.

With an anti-slip pad on its back, the VR Call Point can be wall-mounted or placed on any flat surface. The VR Call Point also transmits supervisory and low-battery signals to our response centre so we can ensure its proper operation at all times.



**Emergency Response by  
Healthcare Professionals**



INS LifeGuard

## LifeGuard VR Call Point

### Features & Benefits

- Emergency alarm with voice recognition
- Voice-triggered activation and keyword / command detection
- Large manual button to trigger Help Alarm
- Wall-mount or desktop placement
- Sleek, modern design
- LED indicators
- Automatic low battery reporting
- Regular supervision signals to check system integrity

Features subject to change at the discretion of INS LifeGuard.

### Specifications

|                              |                                       |
|------------------------------|---------------------------------------|
| <b>Frequency:</b>            | 433 MHz                               |
| <b>Power supply:</b>         | 5V/1A, AC Adapter                     |
| <b>Backup battery:</b>       | 3V, E93 C-Type Alkaline batteries x 2 |
| <b>Backup battery life:</b>  | 1 year*                               |
| <b>Operating temperature</b> | -10°C to 45°C (14°F to 113°F)         |
| <b>Operating humidity</b>    | Up to 85% non-condensing              |
| <b>Dimensions:</b>           | 89 mm x 99 mm x 37 mm                 |

\* Note: Actual battery life may vary with product settings, operating environment and usage.

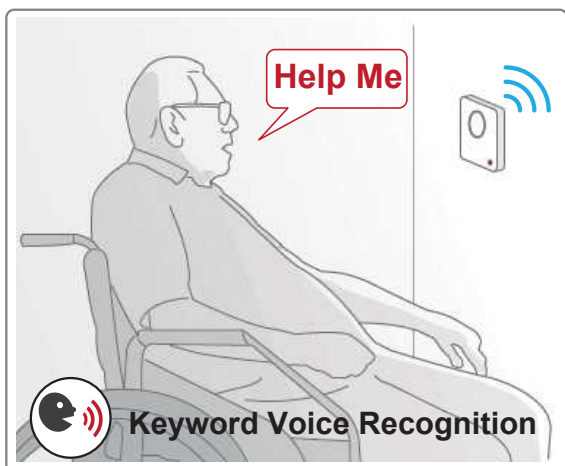

Keyword Voice Recognition

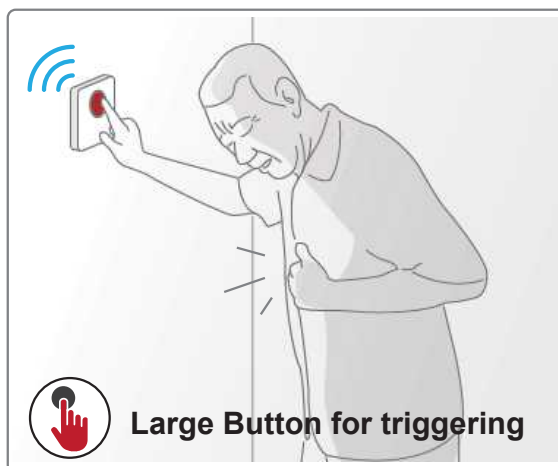

Large Button for triggering